

GROUND FLOOR : 17,553 SFT.
TYPICAL FLOOR : 17,553 x 4 - 70,212 SFT.
(4 FLOORS)

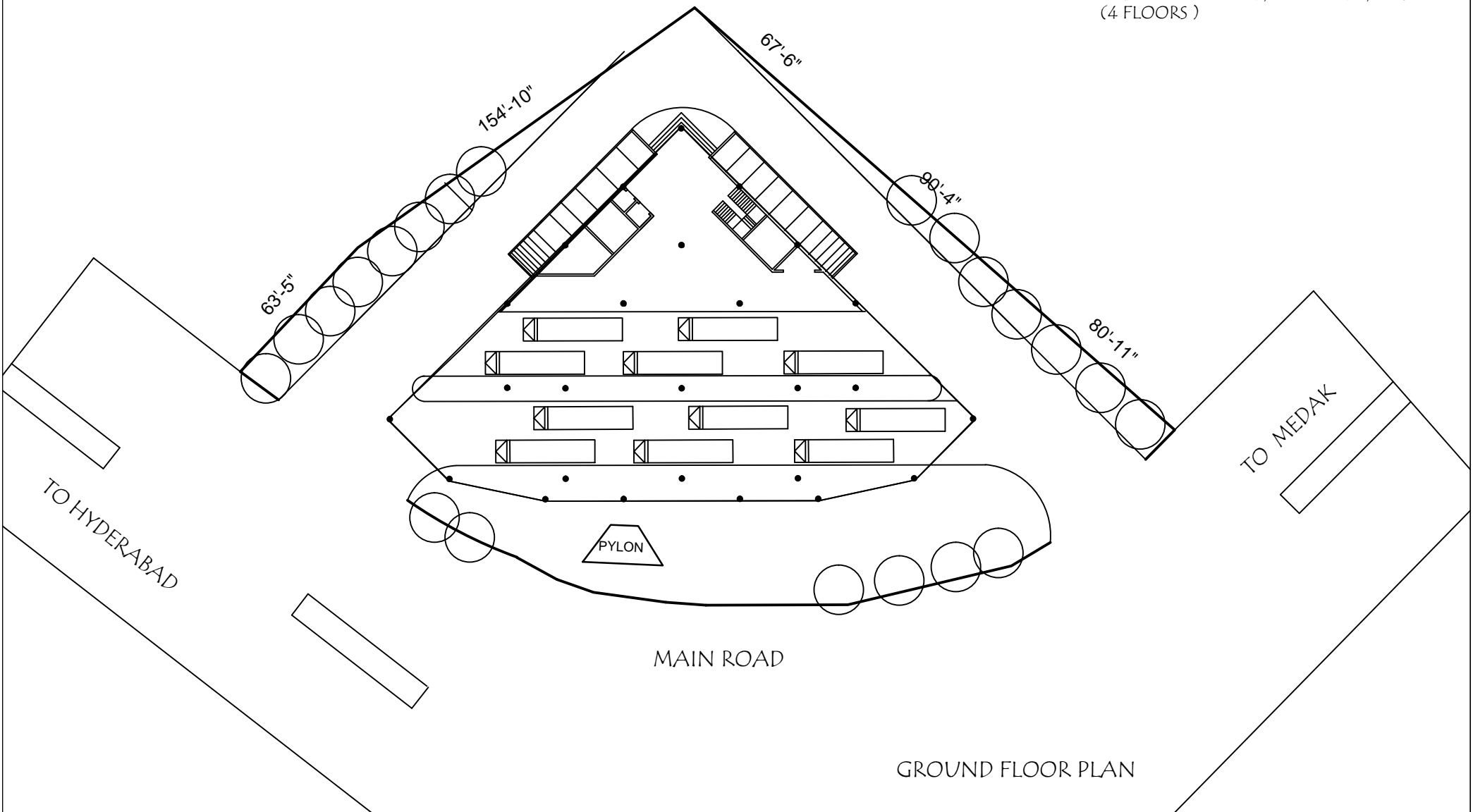

GROUND FLOOR PLAN

PROPOSED BUS STATION cum COMMERCIAL COMPLEX AT OLD BUS STATION PREMISES AT SIDDIPET